

Stainless Steel Pin & Barrel Emergency Rescue Hardware System



A508 Double Acting Hinge A509 Emergency Rescue Stop

Healthcare Facilities · Behavioral Health ·
Food Service · Education · Hospitals

Technical Specifications:

- Hinge Material: 304 Stainless Steel
 Finishes: Satin Stainless – Other finishes by request
 Fasteners: Pin-In-Torx Screws
 BHMA: Meets ANSI/BHMA 156.26
 ADA: Meets barrier free requirements of ICC/ANSI A117.1-2009 and ADAAG-2010

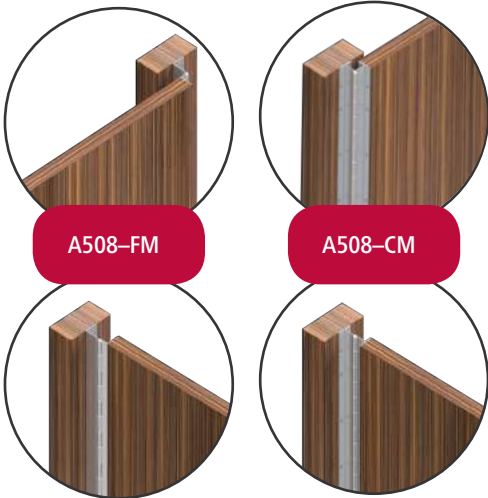

A508 Double Acting Hinge

The ABH Double Acting Hinge allows a door to swing in either direction, comes in two options:

- **A508-FM** – Flush Mount
 - No exposed fasteners to patient
 - Mounted flush to inside door face
- **A508-CM** – Center Mount
 - Mounted in center of door
- Stainless Steel provides a more durable finish and cleaner look than aluminum
- Patented Pending "No see through" design
- Welded Hospital Tip standard
- CMS compliant

A508 Double Acting Hinge

FM – Flush Mount

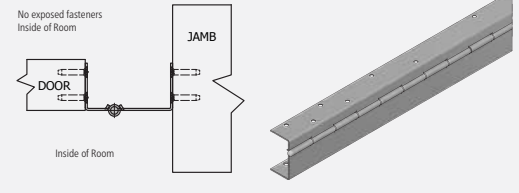

CM – Center Mount

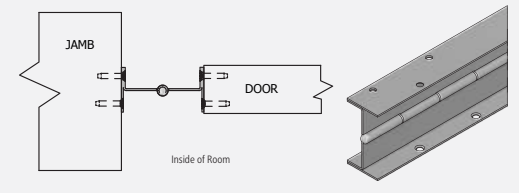

A509 Emergency Rescue Stop

In an emergency situation the stop is manually pulled back to allow the door to move in the opposite direction. The emergency rescue stop comes standard with a welded hospital tip

- Stainless Steel provides a more durable finish and cleaner look than Aluminum
- Can be installed on a cased open frame or standard frame
- Can be installed 1/8" Inset or Center Hung
- Comes standard as spring close option
- Locking option available (L)
- Welded hospital tip standard

A509 Emergency Rescue Stop

Shown as 1/8" Inset Install

Shown as Center Hung Install

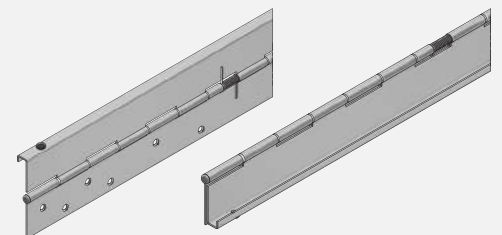
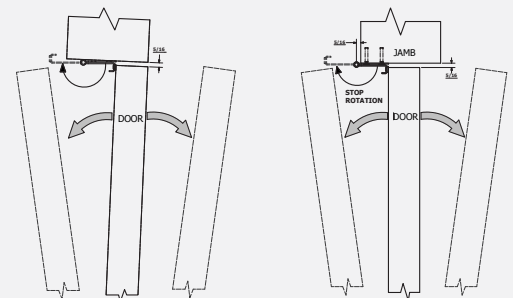

A508 Double Acting Hinge:

Actual Hinge Height	Nominal Door Height
83-1/8"	7' 0"
95"	8' 0"
118-3/4"	10' 0"

A509 Emergency Rescue Stop:

Actual Stop Height	Nominal Door Height
83-1/8"	7' 0"
95"	8' 0"
118-3/4"	10' 0"

Notes: Minimum 2 3/4" backset for hardware trim to clear stop
 Behavioral health product applications are intended to provide a safer solution than traditional applications, they do not eliminate the risk that an object can be affixed to, or around them.

Tel (630) 875-9900
 Fax (800) 932-9224
 www.abhmfg.com
 abhinfo@abhmfg.com